

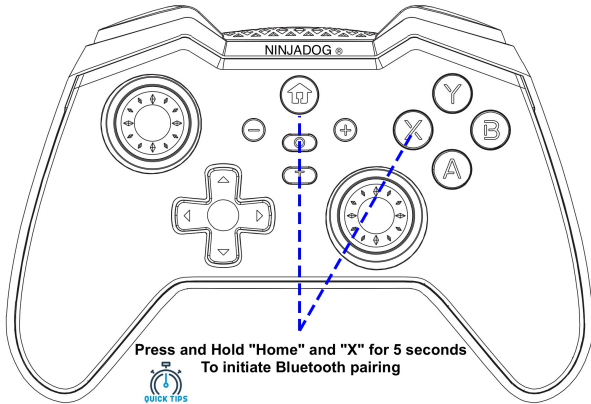

# ASTRA HALL-E

## LAYOUT DIAGRAM/ Quick Start



## Initial Usage/ Getting Started

### Windows/ iOS/ Android/ TV OS

1. Press and Hold "X" and Home button for 3 seconds till controller lights flash Green rapidly
2. Navigate to Bluetooth Settings and scan for new devices
3. Connect and Pair to the Wireless controller
4. The controller lights will turn solid Green - Your controller is now ready to use
5. Note: After the initial pairing, please use only a brief press of home button for power On
6. Press and Hold Home to Power Off. Your controller will also auto power off after extended period of non usage.

### Wireless with Dongle (Windows PC)

1. Insert the supplied Dongle on your PC
2. Press the pairing button on the dongle briefly (see image- the red LED on dongle will start flashing quickly
3. Press and Hold "B" and Home button on controller for 3 seconds till controller lights starts flashing White rapidly
4. Hold the controller close to the dongle- the controller lights will turn solid Green - Your controller is now ready to use

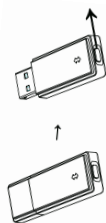

### Windows PC - Wired

1. Connect the Type-C port of the controller with a USB port on the PC with the supplied cable
2. Once your controller is detected on the PC, the LED will turn solid green
3. You are ready to play.

### Compatibility with Nintendo Switch

1. Press and Hold "Y" and Home button for 3 seconds till LED starts flashing White rapidly
2. Navigate to Home Pages> Controllers > Change Grip/Order on your console
3. The controller should connect in a few seconds and the LED will turn solid
4. The colour of the LED will depend on the user assigned by the console
5. You can also wake your console from sleep with the Home button! You are ready to play.

### Legacy Android/ Older Android Devices

1. Press and Hold "A" and Home button for 3 seconds till LED starts flashing Blue rapidly
2. Navigate to Bluetooth Settings > Scan
3. Connect and Pair to the controller
4. Light will turn solid Blue after successful connection

## OTHER FEATURES

### A. High Definition Rumble:

- HD Rumble is primarily meant for Switch. Current Games on Windows provide normal haptics
- Press and Hold the "T" button (Turbo) and move the Left Stick Up/Down to choose haptics level
- You can cycle between 4 level adjustments between 0-30%-70%-100%

### B. Joystick Range adjustment

- Press and Hold the "T" button (Turbo) and press L3/R3 to adjust range for the Left/Right sticks
- You can cycle between 3 range adjustments between 40%-75%-100% with the default at 100%

### C. Turbo Function

- This section uses the "A" button as an example. Replace "A" with another key as needed
- Press A and then T (Turbo) to activate normal Turbo function

- Press A and then T (Turbo) again to activate continuous Turbo function for A
- Press A and then T (Turbo) for 3rd time to disable Turbo function for A
- While in Turbo mode, Press and Hold Turbo + Right Joystick Up/ Down to adjust turbo speed between 5hz, 12hz and 20hz
- To clear all Turbo Functions, Press T and "-" key for 1 second

### D. ReCalibration

- If you feel that the joysticks are not running fully calibrated/ balances, you can reset the calibration
- Press and Hold "B", "-" and Home key for 3 seconds till LED flashes Red, Green & Blue.
- Place the controller on a flat surface and ensure that the sticks are centred and not moving
- Press the "+" key to start calibration
- Controller will turn off after 2 seconds to complete process

### E. Sub Mode Switching

- You can switch between different sub modes by pressing and holding "-" and "+" button together. For example in PC mode, you can switch between xinput and dinput mode.

### F. Power and Charging

- You can use the supplied cable for charging with a USB adapter or PC USB port
- Charging/ Full Charge: The LED indicator will flash while charging and turn off when fully charged
- Low Charge: The LED will blink slowly to indicate low charge alarm

### G. RESET / Factory Mode

- In the event of any abnormal behaviour, you can reset the controller back to factory settings. Please user a SIM ejector tool to briefly press the reset button located under the reset pin-hole at the back of the controller

## SUPPORT



Please scan the QR code above to access online manual and guide. For additional support/ other inquiries, please visit our website <https://ninjadog.in> and use the support form. Alternatively, you can email us at [support@ninjadog.in](mailto:support@ninjadog.in)